

T991 Synchro-Tilt

This low profile Synchro-Tilt mechanism has a 2:1 seat to back ratio. The T991 was developed for a two piece chair and comes with the Top Activation Option. The JBUM option allows 2.25" or 3.00" wide j-shaped back uprights to be assembled to the mechanism providing back depth adjustment.

The T991 ST JBUM mechanism can also be equipped with the single position tilt lock option that is adjusted with a lever located at the front of the mechanism.

A welded Euro Back (EB) is also available which allows the most popular back upright feature to be assembled to the mechanism.

Manual height adjustment is available with a spindle, bell and washer combination.





Specifications

Mechanism Features:

- TA · Top Activated Seat Height
- TL · Single Position Tilt Lock
- JBUM · J-Shaped Back Upright Manual (depth adjustment)
- EB · Euro Back Upright Attachment
- Plastic Shroud · An optional aesthetically pleasing plastic cover is available to streamline the appearance of the mechanism

Gas Cylinder Tapers:

- 17-26
- 17-E Extruded 17-4 Taper

Mechanism Angles:

- Seat · Forward tilt 3.5° rearward
- Back · Forward tilt 1° rearward
· Rearward tilt 21°

Seat Plate Mounting View

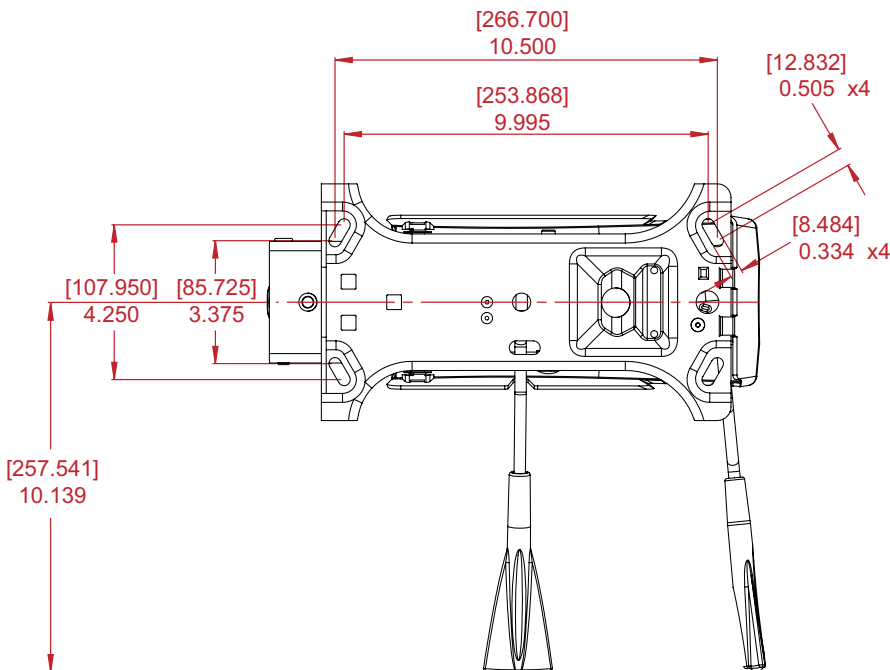

Northfield Metal Products Ltd.

195 Bathurst Drive
Waterloo, ON N2J 3Z9 CANADA
☎ 519-884-1860
☎ 1-866-362-9301 (Canada/USA)
☎ 1-800-362-9301 (International)
☎ 519-884-5476
✉ sales@northfieldmetal.on.ca



NORTHFIELD METAL PRODUCTS

A division of *Leggett & Platt* Ltd.

© 2009 Northfield Metal Products Ltd. The shape of a Northfield Chair Control is a TRADE-MARK of Northfield Metal Products. The shape is your guarantee that you have purchased a genuine, high quality product made by Northfield. Northfield Metal Products Ltd. is a division of Leggett & Platt Ltd. Printed in Canada.



Manufacturer certifies that this product meets or exceeds applicable ANSI/BIFMA standards.

